

# GeneGnome XRQ Chemiluminescence Image Capture - Quick Guide

## 1 Start GeneSys software

➔ Each user can enter a name or title for their own individual user preferences

## 2 Home screen

➔ Select Blots from the home screen



## 3 Open drawer

➔ To close the drawer push the drawer shut

➔ To open the drawer after capture press the blue  arrow



## 4 Sample selection

➔ Choose if you wish to capture a single image or perform a series capture

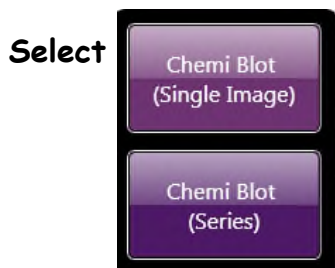

## 5 Auto (Single) Dye selection

➔ Select the chemiluminescent substrate that you are using from the list on screen

➔ Use the search box to quickly find dyes within the list or if it is a dye that you have used before check the 'Recent selections only' to display the recently used dyes

➔ Check the 'Visible marker' box if you wish to image a marker

➔ Click large green bouncing arrow to move to next screen

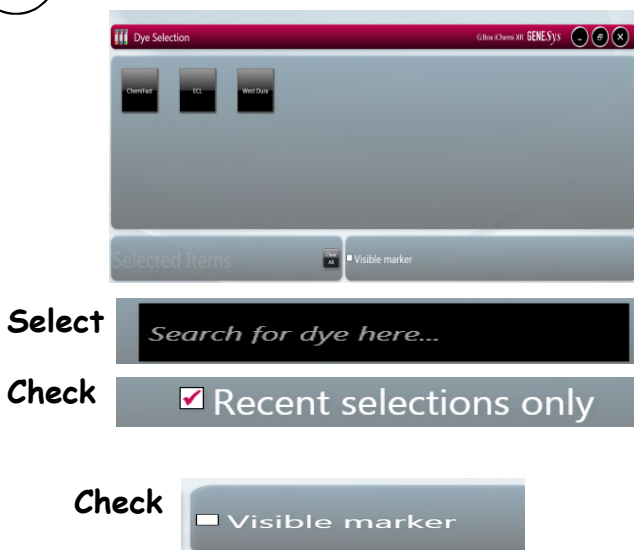

6

## Sample positioning

- ➔ If you have bright and faint bands on the same blot, to be able to see fainter bands you can select to use the auto expose area
- ➔ Position the yellow rectangle over the area of faint bands
- ➔ Click large green bouncing arrow to move to next screen

7

## Auto (single) Capture

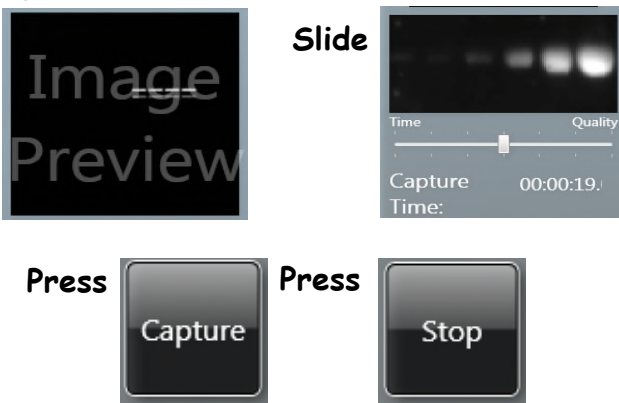

- ➔ Image preview - the software captures a quick image of the chemi blot
- ➔ Image preview - slide the 'Time/Quality' bar until you are happy with the capture time. For a high quality image position the slider bar towards the Quality side
- ➔ To capture an image press the 'Capture' button
- ➔ To stop image capture at any time press the 'Stop' button

8

## Series capture set-up

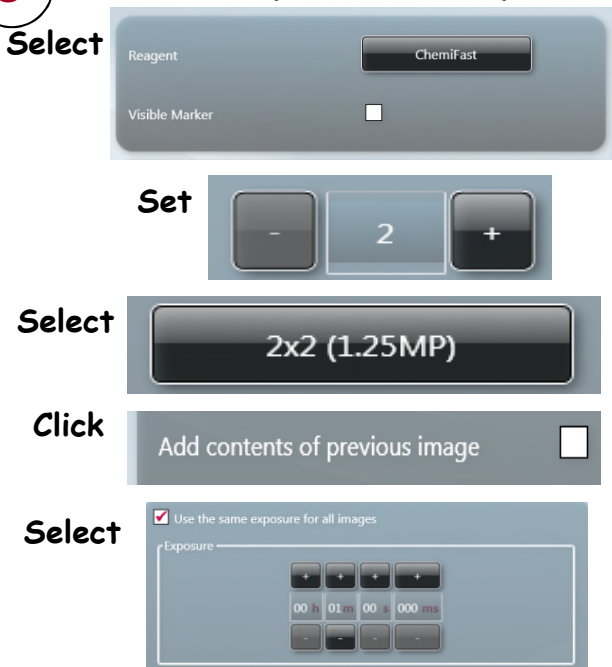

- ➔ Select the chemiluminescent substrate that you are using by clicking on the reagent name then select from the drop down list
- ➔ Check the 'Visible Marker' box if you wish to image a marker
- ➔ Set the number of images you wish to collect. Use the +/- to add or decrease the number of images
- ➔ Select the level of binning you wish to use. The default is 2x2
- ➔ Click the check-box if you wish to add the contents of the previous image
- ➔ Select to use the same exposure time for each image or manually select the exposure time for each image
- ➔ Use the +/- buttons to increase or decrease the exposure time

## 9 Open drawer

Select

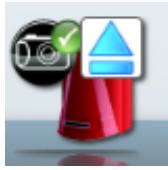

➔ To close the drawer push the drawer shut

➔ To open the drawer after capture press the blue arrow 

## 10 Print and save

Click



➔ Click on the printer icon to send image to printer

Click



➔ Click Save and choose to save image as a TIF, BMP or JPEG

CONTACT SYNGENE:  
EUROPE:  
Tel: +44 (0)1223 727123  
Email: [support@syngene.com](mailto:support@syngene.com)

USA:  
Tel: 800 686 4407/301 662 2863  
Email: [support@syngene.com](mailto:support@syngene.com)

[www.syngene.com](http://www.syngene.com)

GGXRQCIC0216